



# TECHNICAL & HOSPITALITY RIDER 2024

cryptaofficial.com

QUESTIONS/DOUBTS:

**Kaka (booking agent): +55 91 989409205**

**[kaka@xaninhodiscos.com.br](mailto:kaka@xaninhodiscos.com.br)**

## Contents:

1. Travel Party
2. Hotel requirements / Rooming List
3. Hospitality Rider
4. On stage

Updated: May/2024



## 1. TRAVEL PARTY:

(please check with our booking agent or the tour manager about the amount the people on the crew for your show)

### **BAND** (4)

Fernanda Lira (Bass/Vocals)

Luana Dametto (Drums)

Tainá Bergamaschi (Guitar)

Jessica Di Falchi (Guitar)

### **CREW** (4)

2 roadies / producer

1 monitor engineer

1 FOH

**Upon Arrival - Shuttle:** In case the band needs to be picked up/dropped off at airports, a shuttle should be provided by the promoter, free of charge for the band. The shuttle should be a van preferably ([cars, uber and taxis won't be accepted](#)), with enough room for all the BAND and CREW and for the baggage listed below:

- 1 cymbal case (66 x 64 x 16 cm)
- 1 bass hard case (approx. 119 x 34.5 x 7 cm)
- 2 ENKI guitar hard cases (approx. 120.65 x 45.72 x 26.67 mm)
- 2 hard rack/gear cases (56.9 x 23.1 x 41.2 cm and 56.90 x 32.00 x 41.15 cm)
- 5 LARGE suitcases (80 x 45 x 30 cm - drum hardware and snare drum, merchandise and stage props)
- 8 personal hand luggage
- 8 backpacks

**\*\* A shuttle service must also be provided that is available for any other route required (airport to hotel, hotel for lunch/dinner, hotel to venues, etc.) \*\***

**CONTINUES >**



## FLIGHTS / LUGGAGE

- Flight tickets should only be bought after the options are sent to and approved by the tour manager.
- Cryptus need **eleven** 23kg pieces of checked luggage bought along with the flight tickets, free of charge for the band, as well as **two** pieces of hand luggage (one backpack and one 10-12kg suitcase) for each member of the travel party (please check with the tour manager the amount of travelers).
- The band needs the flight tickets bought and sent to the tour manager no later than 1 month prior to the show.

## 2. HOTEL REQUIREMENTS & ROOMING LIST

### MANDATORY

- 3 stars rating minimum
- Inside the city we're playing (no peripheral areas or nearby cities).
- Breakfast included.

### HOTEL ROOMING SPECS:

Band:

- 4 single rooms with private bathrooms and showers

Crew:

- 2 twin rooms (SEPARATE BEDS) with private bathrooms and showers

**\*\* HOSTELS, BAND OR PRIVATE APARTMENTS AND AIR BNBs WON'T BE ACCEPTED \*\***

**\*\* BEDROOMS WITH NO PRIVATE BATHROOMS WON'T BE ACCEPTED\*\***

### Preferably:

- Hotels with elevators or then rooms on the 1st floor (due to loading equipments and suitcases in and out, stairs can be a problem)
- 24 hour reception.

**CONTINUES >**



## TECHNICAL & HOSPITALITY RIDER • 4 of 16

### **\*\*VERY IMPORTANT\*\***

- If the plane tickets or the band's arrival in the city were scheduled before the hotel check-in time, it is mandatory to make an **early check-in** reservation, so that rooms are available as soon as the band arrives at the hotel. The same goes for the band's departure times from the city - if the tickets purchased are after the checkout time, **late checkout** reservation is mandatory, so that the band remains in their hotel rooms until departure time to the airport.
- If upon arrival at the accommodation, the requirements (quality of the room, division etc.) are not met, the promoter must pay the band a daily accommodation sufficient to cover all costs required with a new hotel reservation.

### **< HOTELS ENDS HERE**

## **3. HOSPITALITY RIDER**

### **GUESTS:**

Promoter should provide Crypta 15 tickets/guest list spots, free of charge.

### **DRESSING ROOM:**

- At least one medium-sized mirror
- 7 fresh towels
- Working power sockets
- Wi-fi Connection
- Working toilet
- 1 Electric kettle
- Trash bin
- Napkins and cutlery

### **CONTINUES>**



## Catering •

### **VERY IMPORTANT! Dietary Restrictions:**

- 1 vegan band member (check with tour manager if there's more in the crew)
- Severe allergy to spicy food & sea food

**\*\*\*\*PLEASE AVOID WASTE, PROVIDE A REASONABLE AMOUNT OF ITEMS, WITHOUT EXAGGERATION\*\*\*\***

### **Drinks:**

- 32 bottles of still water (NO SPARKLING), both cold and room temperature options.
- 2 bottles/cartons of orange juice (REAL JUICE PLEASE)
- Soft drinks (if Coca-Cola, please include **both** regular and sugar free options)
- 1 carton of chocolate vegan milk
- Assorted tea bags (preferably infusions, avoid green and black tea)
- Gatorade
- 3 bottles of Kombucha
- 6 cans/bottles of Tonic Water (preferably sugar-free)
- Coffee (FRESH)
- 1 bottle of red wine
- 2 bottles of beer

### **Fruits & Vegetables:**

- Platter of fruits (bananas, apples and grapes only)
- Snack tomatoes, baby carrots and salt.
- Ginger for the tea

**CONTINUES>**



**Bread & Deli:**

- White and whole wheat bread
- Platter of deli meats (salami and ham only) and cheeses
- Platter of assorted vegan deli meats (salami) and vegan cheeses
- Hummus, babaganoush or other vegan spreads.

**Snacks & Sweets:**

- Packages of chips (salted only, non flavored)
- Packages of nuts
- Chocolate bars (milk and vegan options)
- 2 Kinder Surprise (not Joy!)
- Gummy bears and similar (including vegan options).

**< DRESSING ROOM ENDS HERE**

**MEALS:**

Lunch and dinner must follow the requirements below:

- **No** fast food (eg.: hamburger **will not** be accepted as dinner)
- **No** spicy food (**severe allergy**)
- **No** seafood or fish (**severe allergy**)
- Restaurants that include 'normal' and vegan options on the menu. (A good buffet is always the easiest option).
- The band **is not open** to eating in a completely vegan restaurant, therefore there must be either a restaurant that has both options (vegan and regular) or two different restaurants must be chosen (one for the vegans, another one for the rest).

**ABOUT VEGAN MEALS:**

- If the restaurant chosen by the promoter does not have vegan options, the vegan band members / crew must be taken separately to a vegan restaurant, or paid a 25 dollar buyout.
- Tip: The "Happy Cow" app shows you vegan restaurants near you!
- For the vegan option, only salad or pasta **WILL NOT BE ACCEPTED**.

**CONTINUES >**



## TECHNICAL & HOSPITALITY RIDER • 7 of 16

- Below you can find some examples of vegan foods to ask at restaurants:

PROTEINS: (tofu, soy meat, vegan burgers, beans, lentils, chickpeas, peas)

CARBOHYDRATES: (rice, quinoa, potatoes)

VEGETABLES (mushrooms, zucchini, eggplant, pumpkin, cauliflower, asparagus, carrots)

GREENS: (broccoli, kale, spinach, arugula, etc.)

- If you have any questions, please contact our producer with advance.

### **AFTER THE SHOW:**

- At least 5 pizzas (including vegan and regular options).

**< LUNCH/DINNER ENDS HERE**



#### 4. ON STAGE

## TECHNICAL RIDER CRYPTA



**It's mandatory that the techs responsible for the sound and light for the show get in touch with the tour manager, even if everything is according to the technical requirements already. This contact should be made via email or phone. In case of any needed change on this tech rider or any doubts, please check the possibility with our agent or tour manager.**

Produção: Kaka: 91 989409205

Produção Técnica: Rodolfo Duarte: 11 971673195

Email Contato: [kaka@xaninhodiscos.com.br](mailto:kaka@xaninhodiscos.com.br) ou  
[rodoxsoundpro@gmail.com](mailto:rodoxsoundpro@gmail.com)



## **SOUNDCHECK**

- We kindly ask it's made sure that during soundcheck there's no one attending the stage and crowd area, except for anyone from the production or venue staff, other bands that will play on that same day, or anyone previously authorized by Crypta's tour manager.

## **SOUND**

- The promoter must provide at least 2 properly trained employees for the operation and assembly of the entire sound infrastructure, from the time of arrival of the band's equipment until the end of the show.
- We kindly ask that there's spare plug adaptors available for the band, in case it's needed last minute.

### **SOUND INFRASTRUCTURE:**

#### **P.A. SYSTEM:**

System in perfect working order, sized appropriately for the location, optimized (aligned) for sound distribution in most of the audience area.

**CONTINUES>**



**Mixing desk:**

Yamaha CL or QL series, RIVAGE PM10, M7CL, PM5D, Digidesign VENUE, MIDAS M32, Soundcraft VI 1000, 2000, 3000.

**MONITORS:**

Monitoring wedges in perfect working order, with enough power to handle a stage at high volume.

## **BACKLINE**

**STAGE:**

1x mic stand (sturdy and in good condition)  
1x 20" floor fan (a powerful one with strong airflow!)

**Drums:**

In order of preference: **TAMA** or DW, Mapex, Pearl, Yamaha

- 1 kickdrum (22")
- 3 Toms (8", 10," 12")
- 2 Floor Toms (14", 16")

**CONTINUES>**



- 1 Snare (14")
- 1 Drum Throne
- 1 rug (2x2m)

**DRUM STANDS:**

- Toms need to be attached to the kickdrum (very important!)
- Examples of options for the 2 toms:

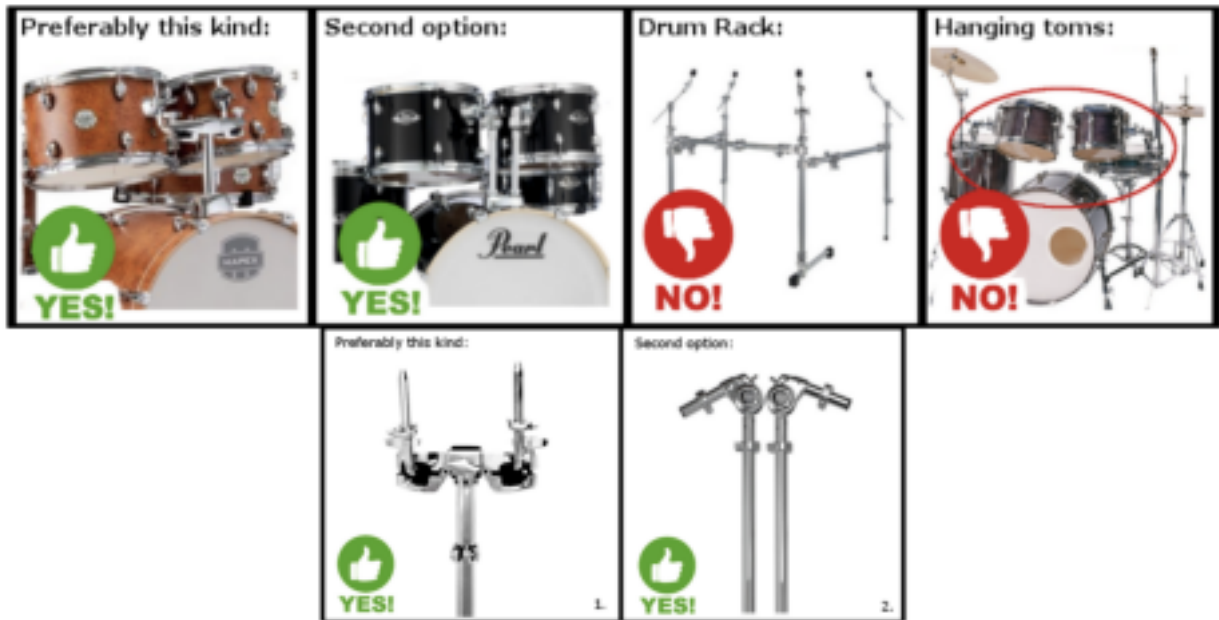

**CONTINUES>**



- Examples for the third tom:



- 1 single tom holder for the third tom
- 1 Clamp (to connect the third tom to the stand)
- 5 foldable cymbal stands
- 1 hi-hat stand ( two-legged, for double bass drum pedal)
- 1 snare stand
- Power outlets and wedges according to the stage plot.

**IMPORTANT: ALL EQUIPMENT MUST BE IN PERFECT CONDITION, PROPERLY WIRED AND WITH ALL ITEMS COMPLETE FOR A TOTAL USE OF THE EQUIPMENT. ALL MODELS ARE IN ORDER OF PREFERENCE, PLEASE RESPECT IT.**

CONTINUES>



## MONITORING

> Crypta travels with their own in-ear monitoring system with splitters.  
All channels must go through the splitters and then to the house's stage box.

### **DRUMS** • Luana Dametto

In ears

### **GUITAR 1 • STAGE RIGHT** • Jessica Di Falchi

In ears

Floor wedges (as a backup):

-100% guitar 1 (SR)

-70% guitar 2 (SL)

-No vocals

-No bass

### **GUITAR 2 • STAGE LEFT** • Taina Bergamaschi

In ears

Floor wedges (as a backup):

-100% guitar 2 (SR)

-70% guitar 1 (SL)

-No vocals

-No bass

### **BASS/VOCALS • CENTER** • Fernanda Lira

In ears



**INPUT LIST**

CH	Desc	Mic	Who
01	KK In	TG D71	Crypta
02	KK Out		House
03	SN T	SM 57	Crypta
04	SN B	SM 57	Crypta
05	HH		House
06	TOM 1	D57c	Crypta
07	TOM 2	D57c	Crypta
08	TOM 3	D57c	Crypta
09	FLOOR TOM 1	D58c	Crypta
10	FLOOR TOM 2	D58c	Crypta
11	RIDE		House
12	OH L	I53c	Crypta
13	OH R	I53c	Crypta
14	TRACK L	Direct	Crypta
15	TRACK R	Direct	Crypta
16	BASS DI	Direct	Crypta
17	BASS Spare (not in use)	-	
18	GTR 1 (Stage Right) L	Direct	Crypta
19	GTR 1 (Stage Right) R	Direct	Crypta
20	GTR 2 (Stage Left) L	Direct	Crypta
21	GTR 2 (Stage Left) R	Direct	Crypta
22	VOX (Center)	e835	Crypta



# STAGE PLOT



**USA TOUR 2024**  
TM: ESTEVAM ROMERA  
WHATSAPP: +55 11 98468-9897  
E-MAIL: E@FAMILYMOB.COM.BR



**DRUMS (LUANA)**  
1x KICK DRUM (22")  
3x RACK TOMS (8" IN CLAMP + 10", 12" KICK DRUM HOLDER)  
2x FLOOR TOMS (14", 16")  
1x SNARE (13")  
5x BOOM STANDS + HI HAT (TWO LEGGED)



2x OUTLETS 127V (DRUM LEFT)  
1x DI BOX > 2x 1/4" INPUT FOR SAMPLES PLAYBACK



**BASS/VOCALS (FERNANDA)**  
> OUT DIRECT FROM 1x XLR (MONO)  
2x OUTLETS 127V (BY THE DRUM RAISER)

> SINGER USES IN-EARS <

**GUITAR 1 (JESSICA)**  
> OUT DIRECT FROM 2x XLR (STEREO)  
2x OUTLETS 127V (BY THE WEDGES)



**GUITAR 2 (TAINA)**  
> OUT DIRECT FROM 2x XLR (STEREO)  
2x OUTLETS 127V (BY THE WEDGES)





# LIGHTS

**\*\*CRYPTA will require the venue's light tech\*\***

- NO Blackouts
- NO Smoke!
- NO Strobes
- Always keep the front white spotlight on, especially on the singer
- Use warm colors, matching drum lights
- Avoid red

Thanks!